

## **Landscape Assessment Districts Descriptions and Maps**

	<u><b>Frequency Chart for Landscape Assessment Districts (LAD)</b></u>											
	January	February	March	April	May	June	July	August	September	October	November	December
<u><b>IRRIGATION</b></u>												
Annual System Check			*									
General System Check & Maintenance					*			*			*	
<u><b>WEEDS</b></u>												
Monitor for control	*	*	*	*	*	*	*	*	*	*	*	*
<u><b>LITTER &amp; LEAF REMOVAL</b> (1x per month)</u>												
Hard Surface Areas (Litter Only)	*	*	*	*	*	*	*	*	*	*	*	*
Planted & Mulched Areas Areas (Litter Only)	*	*	*	*	*	*	*	*	*	*	*	*
Leaf Removal	*	*	*	*	*	*	*	*	*	*	*	*
<u><b>TREE MAINTENANCE</b></u>												
Tree Purning for pedestrian and street heights			*									*
<u><b>SHRUB MAINTENANCE</b></u>												
Size Control						*						*
Pruning & Shaping			*			*			*			*
<u><b>GROUND COVER MAINTENANCE</b></u>												
Edging			*			*			*			
Pruning or Mow ing												*
<u><b>PERENNIAL AND TALL GRASS MAINTENANCE</b></u>												
Dead Heading-Shaping					*			*			*	
Cut Back 2/3 Size			*									
<u><b>TURF (w hen present) MAINTENANCE</b> (1x per month)</u>												
Mow ing	*	*	*	*	*	*	*	*	*	*	*	*
Edging	*	*	*	*	*	*	*	*	*	*	*	*
<u><b>HARD SURFACES MAINTENANCE</b></u>												
Extra Work - as Requested												
<u><b>MULCH REPLACEMENT</b></u>												
Extra Work - as Requested												
* See Technical Specifications for Details												

#### **10. St. James Estates – Zone B**

- **Frontage**
  - Curb to the fence between East Madison Street & Wyndham Way
- **Landscape Area**
  - On the south side of Wyndham Way from Sonoma Mountain Parkway to corner from curb to wall.
  - On the east side of Wyndham Way around the corner from corner to end of the subdivision from the curb to wall/fence.

**NOTE:**

For a more detailed description of the lines and dimensions of the parcels, please refer to the County Assessor's maps that formed the District.

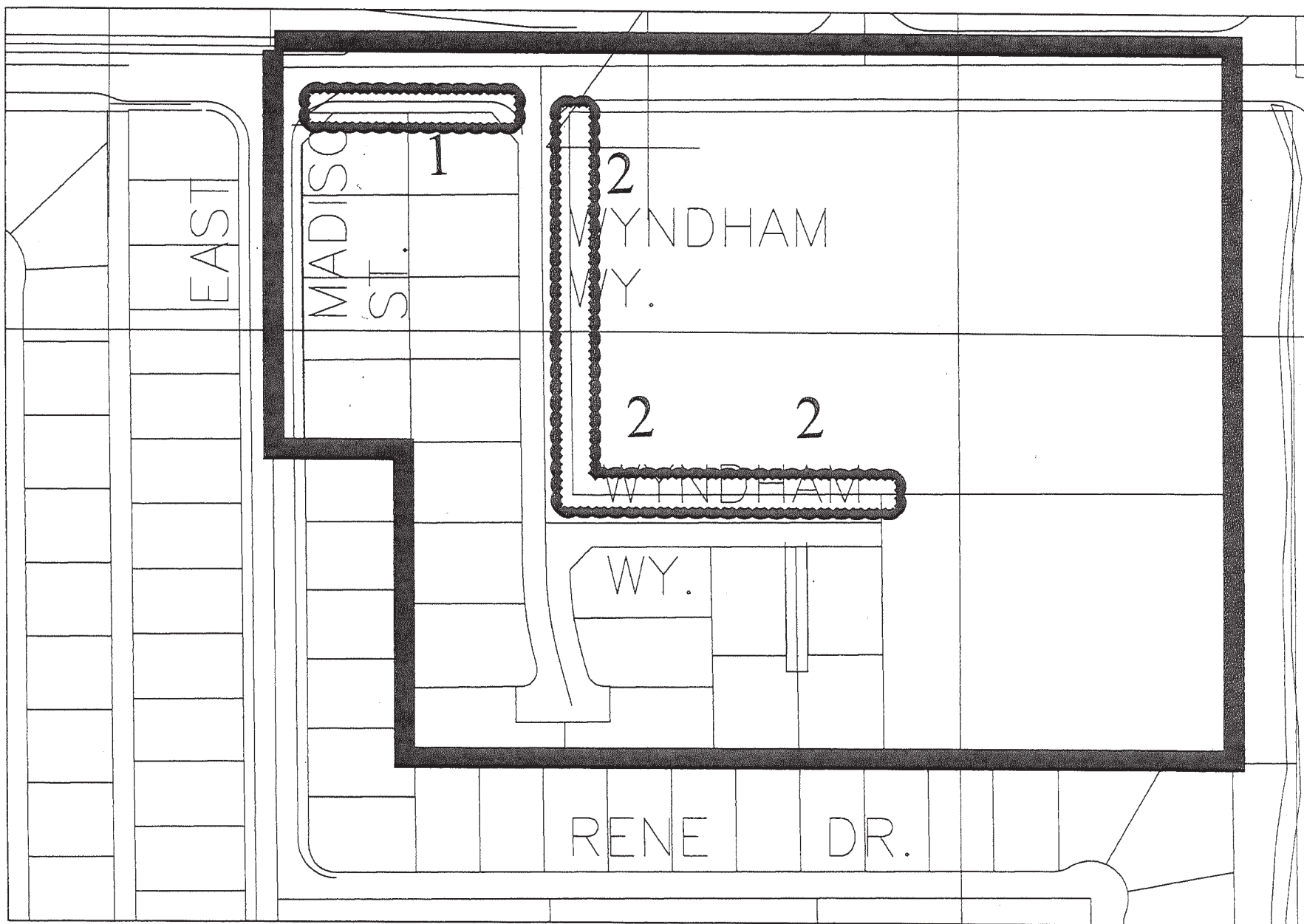

# ST. JAMES - CLEANUP LANDSCAPE ASSESMENT DIAGRAM