

# Lucchesi Skatepark Project

---

PETALUMA CITY COUNCIL

OCTOBER 16, 2023



# Agenda

---

- Project Overview
- Community Engagement
- Concept Plan
- Recommendation & Next Steps

# Overview

---

- Project launched December 2022
- Goal: create vision for skating in Petaluma
- Community wants a new, larger skatepark (20,000+ square feet)
- Site analysis for four City parks completed February 2022
- Community, RMPC, and Council support for Lucchesi Park



# Budget

---

- FY24 budget of \$1.5m includes Design for Phases 1 & 2, construction of Phase 1, and partial funding for phase 2 construction
- \$2.8m planning-level estimate for 23,000 square foot park
- \$275,000 funding gap currently anticipated for Phase 2



*Riverside Skatepark (Detroit, MI) - Designed & Constructed by Grindline*



A photograph of a community engagement meeting in a large room. People are seated at long tables, facing a man on the left who is speaking into a microphone. The room has a high ceiling with exposed ductwork and fluorescent lights. In the background, there are kitchen counters and an exit sign. The text "Community Engagement" is overlaid in white on the left side of the image.

# Community Engagement



## Community Focus

---

- Community-driven project
- Active engagement, both in-person and online
- Received valuable insight through workshops
- Listening sessions between skating, scootering, biking helped process

# Community Engagement

---

Project  
Webpage

Online  
Surveys

Workshops  
x4

RMPC &  
City Council

Community  
Update

Project  
Emails

Social  
Media

Grindline  
Channels



LUCCHESI PARK





# What We Heard: Recreation, Music, & Parks Commission and City Council

---

- Unanimous support for new skatepark at Lucchesi Park
- Preserve and incorporate existing trees where possible
- Council support for two-phase build, with first phase of 10,000-13,000 square feet





# Concept Plan















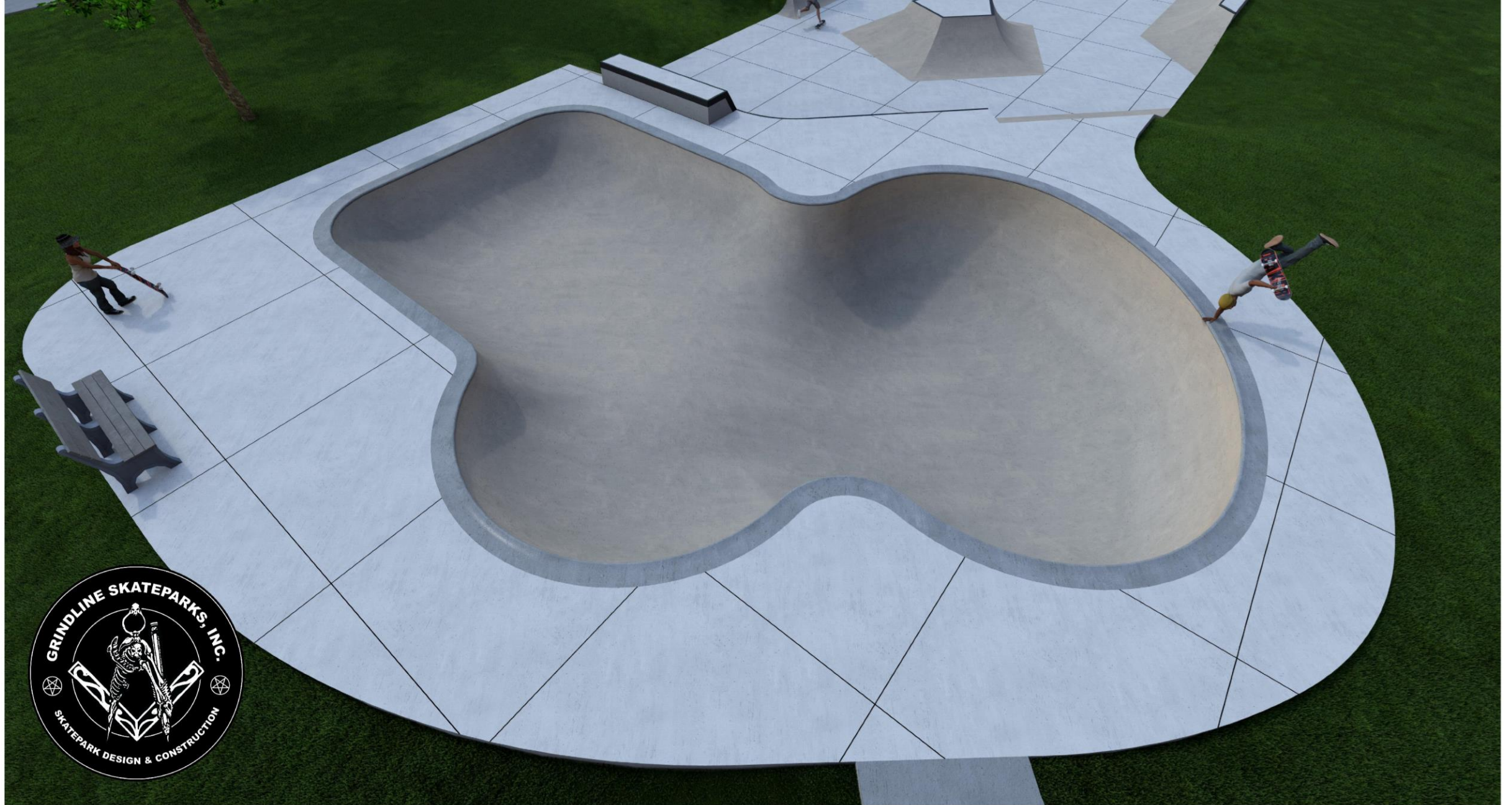











Phase 2

Phase 1





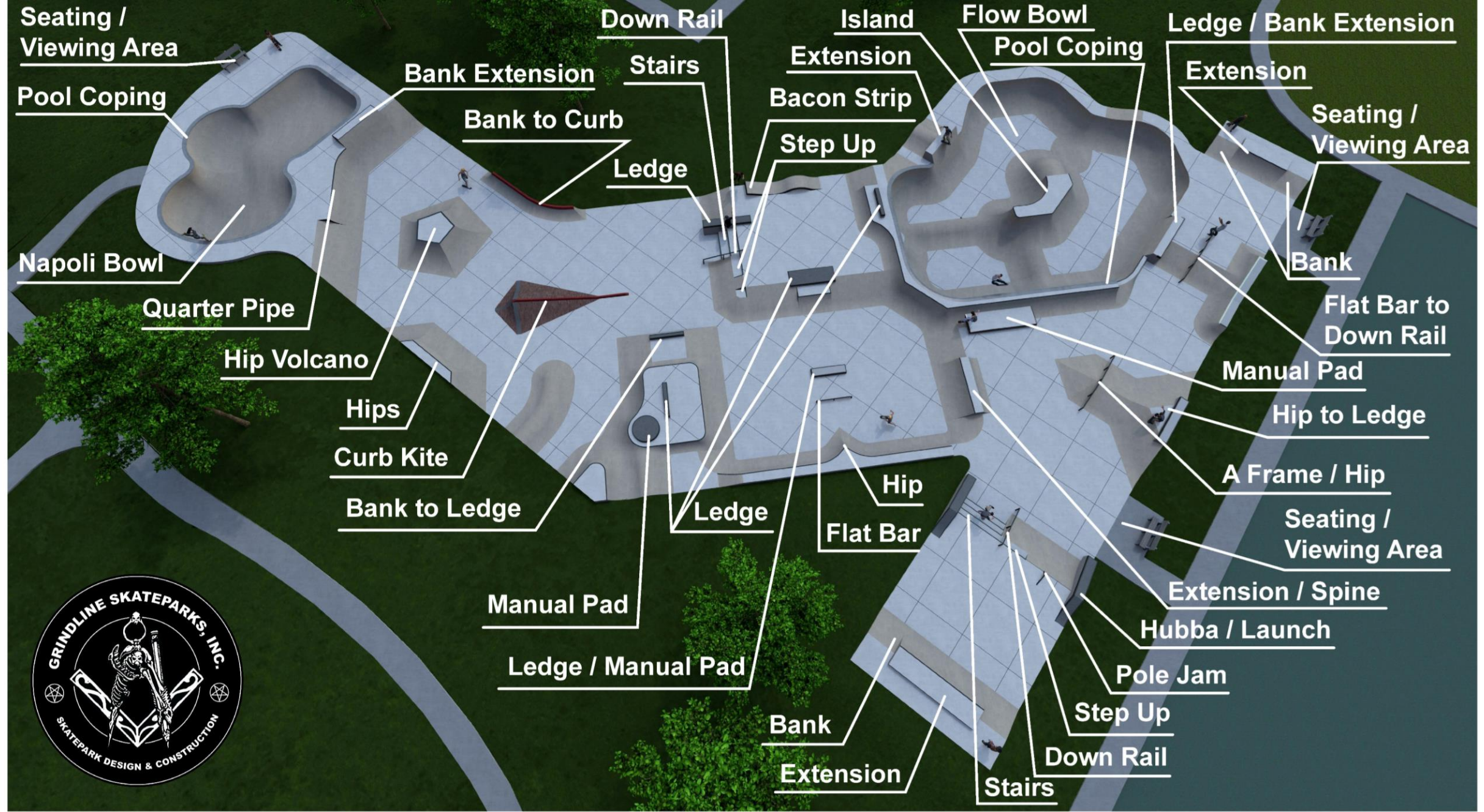







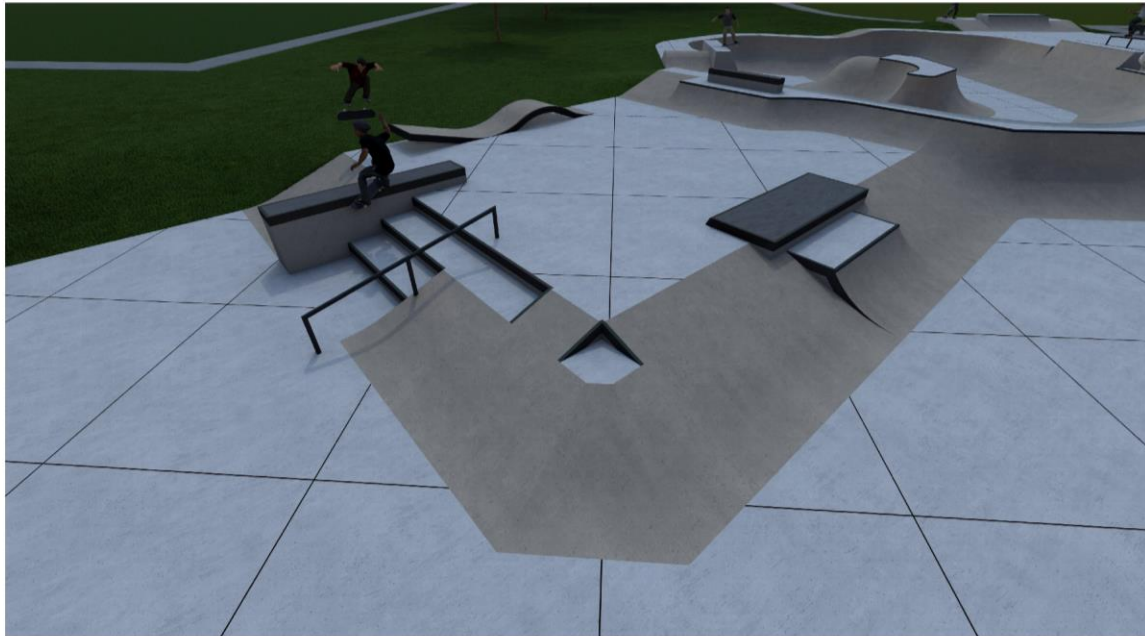
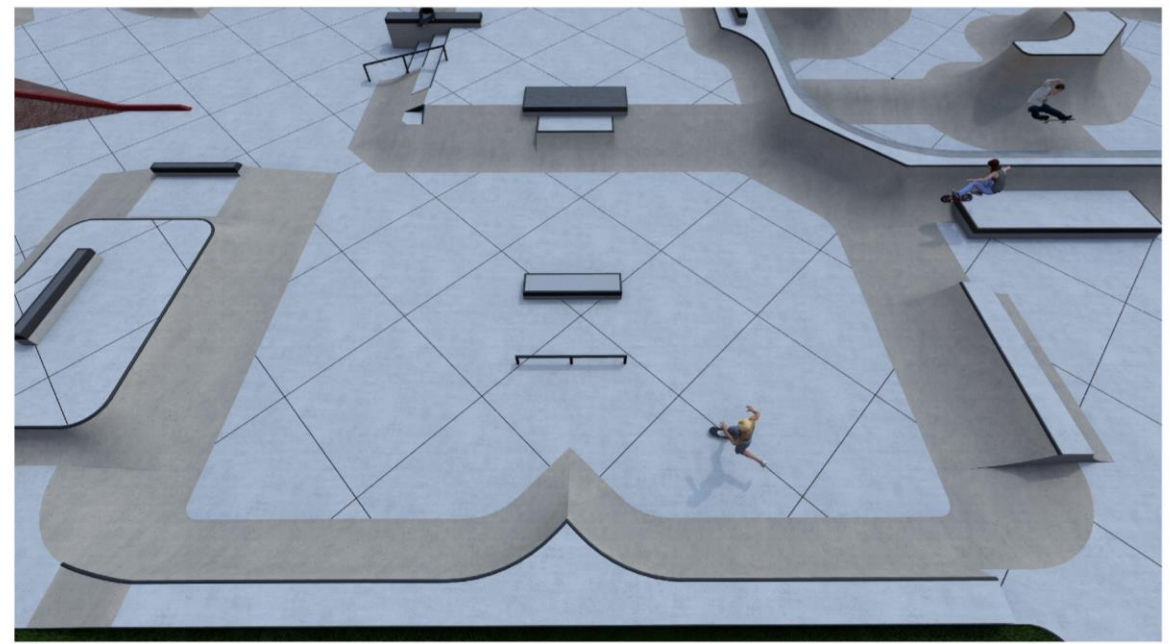





# Recommendation & Next Steps

# Recommendation

---

Approve the concept plan for a skatepark at Lucchesi Park and authorize the City Manager to amend the City's Professional Service Agreement with Grindline Skateparks, Inc. for Plans, Specifications, & Estimates (100% Design)



# Process / Timeline

---

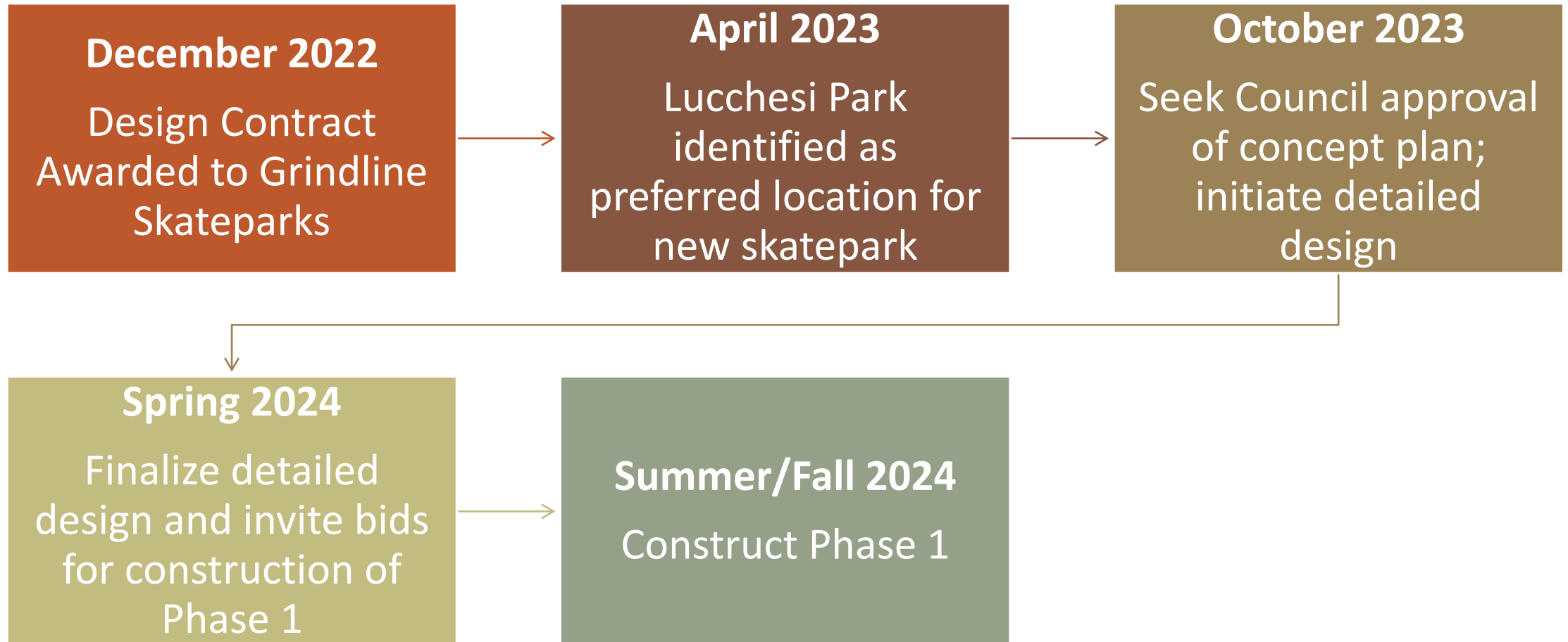



Learn More &  
Subscribe to  
Project Updates!



[cityofpetaluma.org/lucchesi-skatepark](http://cityofpetaluma.org/lucchesi-skatepark)

Bjorn Gripenburg, Project Manager

[bgripenburg@cityofpetaluma.org](mailto:bgripenburg@cityofpetaluma.org)